

### Stainless Steel Butterfly Valves PN16/235PSI/Class125

#### Wafer Style

Design to API609 and MSS SP-67

Flange Dimension to EN1092-2, ANSI B16.1 Class 125

Sealing Performance	
EPDM	-20°C- 120°C
NBR	-10°C- 80°C
VITON	-20°C- 150°C

Hydraulic Pressure Test	
Body	2.4Mpa/24Bar
Seat	1.76Mpa/17.6Bar



#### HB350-G/O

14" - 24"

#### Materials List

No	Part	Specification	BS EN	ASTM
1	Body	Stainless Steel	BS970 316 BS970 304	CF8M CF8
2	Disc	Stainless Steel	BS970 316 BS970 304	CF8M CF8
3	Seat	EPDM NBR VITON	EPDM NBR VITON	EPDM NBR VITON
4	Shaft	Stainless Steel	BSEN 10088-1	A582 420
5	Bushing	VITON	PTFE	PTFE
6	Sealing Ring	Rubber	NBR	NBR

\* Suffix - G for operation by worm gear, - O for polished rod

\* An electric or pneumatic actuator may be mounted to match an ISO5211-based mount.  
Please refer to the TALOAR Butterfly Valve Torque Table in Page 46.

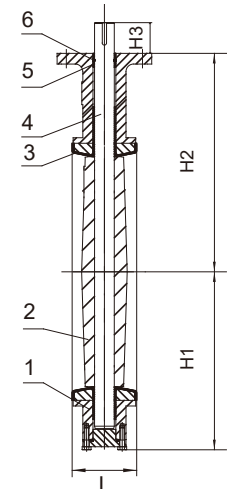
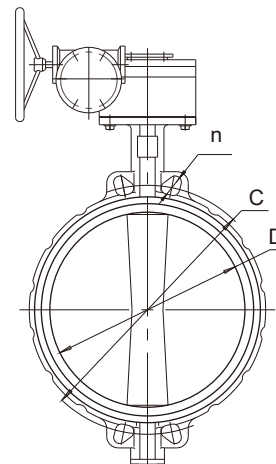

#### Dimensions

mm	350	400	450	500	600	
In	14	16	18	20	24	
L	79.5	90	109	135	157	
H1	262	302	326	360	444	
H2	368	400	422	480	562	
H3	45	51	51	64	70	
D	333.3	389.6	439.9	491.6	592.6	
EN	C	470	525	585	650	770
	n-d	16-27	16-30	20-30	20-33	20-36
AN	C	476	539.5	578	635	749.5
	n-d	12-29	16-29	16-32	20-32	20-35
A	31.8	33.3	38	41.15	50.65	
B	107.95	158.75	158.75	158.75	215.9	
F	15	20.6	20.6	20.6	22.2	

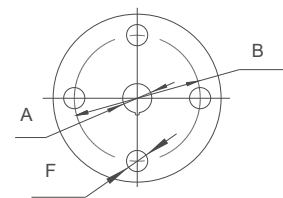

Note: Steam services are not recommended.